

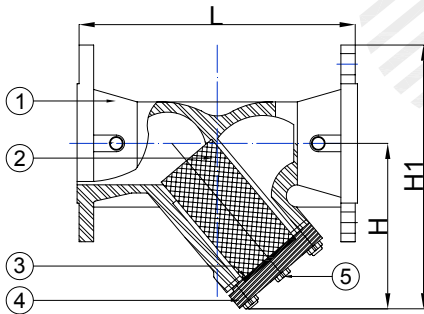

CAST IRON PN 16

CAST STEEL PN 40

DESCRIPTION

VALMATIC™ Y-Strainer is a device for mechanically removing solids from flowing liquids or gases by means of a perforated straining element. It has a strong construction screen with extra an large screen area within the body assuring free flow of fluid with minimal head loss. These strainers are vital to protect control valves, pressure reducing valves, steam traps, pumps and measuring equipments from damage by the scale or dirt in the piping system.

VALMATIC™ Y-Strainer can be installed in horizontal and vertical positions in the piping systems. It is widely used in process industries such as Palm Oil and Refinery Plant, Food Industries, Petrochemical, Heating and Cooling System.

APPLICATION

Suitable for water, steam, oil, gases and non-aggressive media (Refer to corrosion resistance table for valve materials selection).

SPECIFICATION

Face To Face Dimension	- Series 1 according to EN 558-1
End Connection	- Flanged End to DIN PN 16 and PN 40
Mesh Diameter	- 1 mm for DN 15 to DN 50
	1.25 mm for DN 65 to DN 80
	1.6 mm for DN 100 to DN 300
Meshes Screen in cm ²	- 45 for DN 15 to DN 50
	28 for DN 65 to DN 80
	15 for DN 100 to DN 300

MATERIALS

No.	Parts	PN 16 Rating	PN 40 Rating
1.	Body	Cast Iron EN-GJL-250	Cast Steel GP240GH
2.	Strainer Screen	Stainless Steel X5CrNi 18-10	Stainless Steel X5CrNi 18-10
3.	Gasket	Graphite - CrNiSt	Graphite - CrNiSt
4.	Cover	Cast Iron EN-GJL-250	Cast Steel GP240GH
5.	Bleed Screw	Stainless Steel X20Cr13	Stainless Steel X20Cr13

PRESSURE-TEMPERATURE RATINGS ACC. DIN EN 1092-1/2

Pressure Rating And Material	Temperature										
	-10°C	20°C	100°C	120°C	150°C	200°C	250°C	300°C	350°C	400°C	450°C
PN 16 - Cast Iron	16 Bar	16 Bar	16 Bar	16 Bar	14 Bar	13 Bar	11 Bar	10 Bar	-	-	-
PN 40 - Cast Steel	40 Bar	40 Bar	40 Bar	40 Bar	37 Bar	35 Bar	32 Bar	28 Bar	24 Bar	21 Bar	18 bar

DIMENSIONS (mm) AND WEIGHTS (Kg)

Size (DN)	15	20	25	32	40	50	65	80	100	125	150	200	250	300
L	130	150	160	180	200	230	290	310	350	400	480	600	730	850
H -PN 16	90	100	115	135	150	160	180	215	235	280	320	405	540	680
H -PN 40	70	80	88	100	125	140	170	190	225	260	320	420	-	-
H1	135	150	180	215	240	250	285	330	365	425	480	610	915	1110
Weight -PN 16	2.6	3	4.3	6.8	8.8	11	16.8	19.5	34	42.5	56	110	165	285
Weight -PN 40	4	5	6	8	10	13	19	24.5	35	51	71	144	-	-

The specification is subject to change without further notice

VALMATIC ENGINEERING SDN BHD

35, Jalan Layang Layang 4, Puchong Jaya Industrial Park,
Bandar Puchong Jaya, 47100 Puchong,
Selangor, Malaysia

(369320 W)

Tel : 603-5882 6683
Fax : 603-5882 8366
Email : vmatic@pd.jaring.my
http : www.valmatic.com.my