

## APPLICATION

Suitable for water, steam, oil and gases.

## SPECIFICATION - STAINLESS STEEL

Dial Size	4 inch (100mm), 6 inch (150mm)
Accuracy	+/- 1.0% of Full Scale
End Connection	1/2 inch BSPT Thread Bottom Entry
Dial	Aluminium alloy, black graduations and figures on white background
Scale Unit	Dual Scale in P.S.I and Bar
Measuring Range	0 to 10 Bar, 20 Bar and 40 Bar, others range on request
Working Temperature	Up to 200°C

## SPECIFICATION - GENERAL

Dial Size	4 inch (100mm), 6 inch (150mm), 8 inch (200mm), 10 inch (250mm)
Accuracy	+/- 1.6% of Full Scale
End Connection	3/8 inch BSPT Bottom Entry for 4 inch and 6 inch Dial 1/2 inch BSPT, 8 inch and 10 inch Dial
Dial	Aluminium alloy, black graduations and figures on white background
Scale Unit	Dual Scale in P.S.I and Bar
Measuring Range	0 to 5 Bar, 7 Bar, 10 Bar, 15 Bar, 20 Bar, 30 Bar, 40 Bar and 50 Bar, others range upon request
Working Temperature	Up to 80 °C

## MATERIALS

PARTS	FIG. 7PG6	FIG. 7PG
1. Casing and Bezel	Stainless Steel AISI 304	Steel with Black Painted
2. Bourdon Tube	Stainless Steel AISI 316	Brass or Phosphor Bronze
3. Movement	Stainless Steel AISI 304	Brass
4. Connection	Stainless Steel AISI 304	Brass
5. Window	Glass	Brass

## DIMENSIONS (mm)

Dial Size	D	D1	L
100 mm	90	100	38
150 mm	140	150	46
200 mm	188	200	46
250 mm	235	250	48

\*The specifications are subject to change without further notice

## PRESSURE GAUGE

### STAINLESS STEEL/ GENERAL

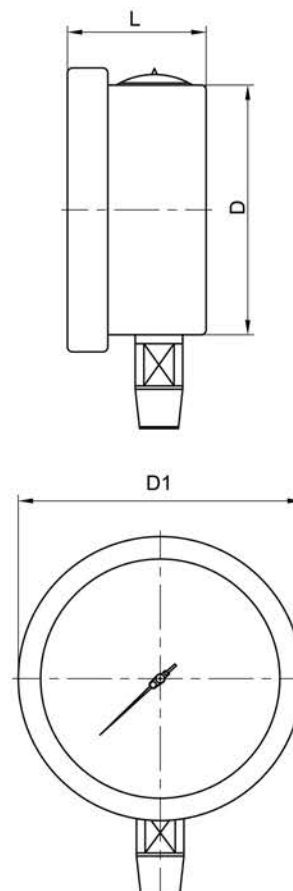

**FIG 7PG6**



**FIG 7PG**