

## Suction Diffuser

FIG. 7109

### Specifications

- Pump protection fitting, Providing in one single compact unit a reducing elbow, a protective strainer and a flow straightener to improve pump performances.
- Removable 20 mesh start up screen for added protection during system start up.
- Oversized diffuser screen.
- Creates a uniform flow to the pump.
- Angled body pattern also designed for reducing pipe size to the pump.
- Drain plug for easy routine cleaning.
- Fully epoxy coated with stainless steel screen for long-lasting corrosion protection.

### Working Pressure and Temperature

- 16 bar/250 psi rated at -10°C to 120°C.

### Corrosion Protection

- Fusion bonded coating or liquid epoxy painted interior and exterior.

### Material Specifications

Part	Material	EN Specification	ASTM Specification
Body	Cast Iron	EN 1561, EN-GJL-250	A126 Class B
Cover	Cast Iron	EN 1561, EN-GJL-250	A126 Class B
Screen	Stainless Steel	EN 10088-3, X5CrNi18-10	A276 Grade 304
Fasteners	Carbon Steel	Carbon Steel, Gr.4.8	A307 Grade B

### Schematic

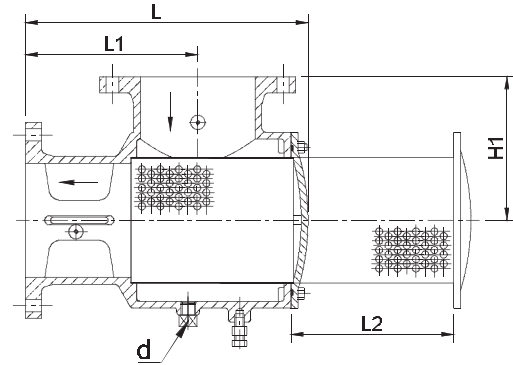

### Main Dimensions (mm)

Size	In	50A	65A	65A	80A	80A	100A	100A	100A	125A	125A	125A	150A	150A	150A	200A	200A	200A	
	Out	50A	50A	65A	65A	80A	65A	80A	100A	80A	100A	125A	100A	125A	150A	125A	150A	200A	
L		211	238	239	264	268	303	303	311	365	369	359	401	406	399	521	495	496	
L1		130	144	146	160	163	186	187	195	238	241	232	258	265	256	326	302	301	
L2		103	126	126	147	147	170	170	170	203	203	203	228	228	228	285	285	285	
H1		102	111	111	128	128	152	152	152	177	177	177	203	203	203	253	251	251	
d		NPT 1/2"-14						NPT 3/4"-14						NPT 1"-11.5					

Size	In	250A	250A	250A	300A	300A	300A	350A	350A	350A	350A	400A	400A	400A	450A	450A	500A	600A	
	Out	150A	200A	250A	200A	250A	300A	200A	250A	300A	350A	300A	350A	400A	350A	400A	500A	600A	
L		591	598	585	711	698	686	782	767	745	751	817	818	819	923	924	950	1080	
L1		362	369	354	448	437	425	495	480	458	464	489	490	491	553	554	550	620	
L2		360	360	360	430	430	430	482	482	482	482	525	525	525	615	615	695	800	
H1		292	292	292	339	341	341	379	379	379	379	402	402	395	429	429	460	550	
d		NPT 1"-11.5																	

### Notes

- Designs, materials and specifications shown are subject to change without notice due to the continuous development of our products.