

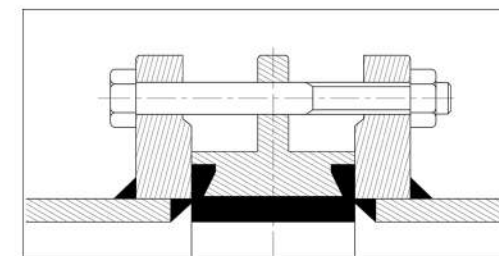

Stud length for tightening DHC wafer design valves between flanges

BOLTING DATA WAFFER TYPE VALVE

Valve Size		JIS 5 kg/cm ² flanges		JIS 10 kg/cm ² flanges		DIN PN 10 flanges		DIN PN 16 flanges		ANSI 150 flanges	
Inch	mm	Studs dia. and length mm	N ° Studs	Studs dia. and length mm	N ° Studs	Studs dia. and length mm	N ° Studs	Studs dia. and length mm	N ° Studs	Studs dia. and length mm	N ° Studs
1 1/2"	40	M12 x 83	4	M16 x 90	4	M16 x 110	4	M16 x 110	4	1/2" x 4 5/15"	4
2"	50	M12 x 100	4	M16 x 110	4	M16 x 130	4	M16 x 130	4	5/8" x 5 1/8"	4
2 1/2"	65	M12 x 100	4	M16 x 115	4	M16 x 130	4	M16 x 130	4	5/8" x 5 1/8"	4
3"	80	M16 x 110	4	M16 x 115	8	M16 x 140	4	M16 x 140	8	5/8" x 5 1/2"	4
4"	100	M16 x 120	8	M16 x 125	8	M16 x 150	8	M16 x 150	8	5/8" x 5 1/2"	8
5"	125	M16 x 125	8	M20 x 140	8	M16 x 150	8	M16 x 150	8	3/4" x 6 3/8"	8
6"	150	M16 x 130	8	M20 x 145	8	M20 x 160	8	M20 x 160	8	3/4" x 6 3/8"	8
8"	200	M20 x 145	8	M20 x 150	12	M20 x 170	8	M20 x 170	12	3/4" x 6 1/4"	8
10"	250	M20 x 165	12	M22 x 175	12	M20 x 180	12	M24 x 190	12	7/8" x 7 1/2"	12
12"	300	M20 x 170	12	M22 x 180	16	M20 x 190	12	M24 x 200	12	7/8" x 8 3/8"	12
14"	350	M20 x 190	12	M22 x 195	16	M20 x 230	16	M24 x 220	16	1" x 8 3/4"	12
16"	400	M22 x 205	16	M24 x 215	16	M22 x 230	16	M27 x 240	16	1" x 10"	16
18"	450	M22 x 215	16	M24 x 230	20	M24 x 250	20	M27 x 250	20	1 1/8" x 11 1/8"	16
20"	500	M22 x 240	16	M24 x 255	20	M24 x 250	20	M30 x 280	20	1 1/8" x 12"	20
24"	600	M24 x 260	16	M30 x 280	20	M27 x 300	16	M33 x 300	16	1 1/4" x 13 13/16"	16
		M24 x 50	8 VITI	M30 x 53	8 VITI	M27 x 45	8 VITI	M30 x 45	8 VITI	1 1/4" x 1 3/4"	8 VITI



BOLTING DATA LUG TYPE VALVE

Screws length for tightening DHC lug design valve between flanges.

Valve Size		JIS 5 kg/cm ² flanges		JIS 10 kg/cm ² flanges		DIN PN 10 flanges		DIN PN 16 flanges		ANSI 150 flanges	
Inch	mm	Studs dia. and length mm	N ° Studs	Studs dia. and length mm	N ° Studs	Studs dia. and length mm	N ° Studs	Studs dia. and length mm	N ° Studs	Studs dia. and length mm	N ° Studs
1 1/2"	40	M12 x 26	8	M16 x 30	8	M16 x 30	8	M16 x 30	8	1/2" x 1 3/15"	8
2"	50	M12 x 33	8	M16 x 35	8	M16 x 35	8	M16 x 35	8	5/8" x 1 1/2"	8
2 1/2"	65	M12 x 34	8	M16 x 38	8	M16 x 35	8	M16 x 35	8	5/8" x 1 1/2"	8
3"	80	M16 x 34	8	M16 x 38	16	M16 x 35	8	M16 x 35	16	5/8" x 1 1/2"	8
4"	100	M16 x 34	16	M16 x 40	16	M16 x 40	16	M16 x 40	16	5/8" x 1 3/4"	16
5"	125	M16 x 41	16	M20 x 45	16	M16 x 45	16	M16 x 45	16	3/4" x 1 3/4"	16
6"	150	M16 x 43	16	M20 x 47	16	M20 x 45	16	M20 x 45	16	3/4" x 2"	16
8"	200	M20 x 47	16	M20 x 50	24	M20 x 50	16	M20 x 50	24	3/4" x 2 1/4"	16
10"	250	M20 x 53	24	M22 x 55	24	M20 x 55	24	M24 x 55	24	7/8" x 2 1/4"	24
12"	300	M20 x 58	24	M22 x 60	32	M20 x 60	24	M24 x 60	24	7/8" x 2 1/2"	24
14"	350	M20 x 60	24	M22 x 60	32	M20 x 60	32	M24 x 60	32	1" x 2 1/2"	24
16"	400	M22 x 72	32	M24 x 76	32	M24 x 70	32	M27 x 70	32	1" x 3 1/4"	32
18"	450	M22 x 78	32	M24 x 84	40	M24 x 80	40	M27 x 80	40	1 1/8" x 3 3/4"	32
20"	500	M22 x 84	32	M24 x 90	40	M24 x 80	40	M30 x 80	40	1 1/8" x 3 3/4"	40
24"	600	M24 x 100	32	M30 x 106	40	M27 x 90	32	M33 x 90	32	1 1/4" x 3 1/2"	32
		M24 x 50	8	M30 x 53	8	M27 x 45	8	M30 x 45	8	1 1/4" x 1 3/4"	8

